



VECTOR
WINDOWS & DOORS

Builders Know The Difference.





About Vector Windows

Vector windows are manufactured in Fergus Falls, Minnesota. This is important because we know the harsh climate first hand and what it takes to build a window that will stand up to what mother nature has in store for this region.

Why Buy Vector Windows?

- Lifetime Warranty
- Superior Quality
- On-Time And Complete Deliveries
- Service You Can Count On
- Customer Service Second To None
- Knowledgeable Staff



Vector Envision Series
Awarded the ENERGY STAR®
Most Efficient in 2020.



Standard Features with Vector Windows



ENERGY STAR® 6.0 Certified
With 272 Low E Glass
(Envision Series)

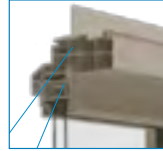

**Multi-chambered
Internal Cavities**
To Optimize Performance

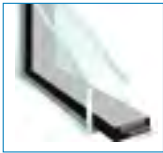

**Non-Metallic Warm Edge
Technology Glass Spacer**

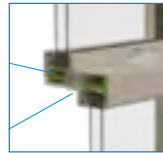

**Innergy® Thermal
Reinforcements**

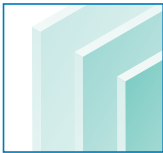

Triple Pane Glass
Available In All Envision



**Fusion Welded
Frames + Sash**



Three Standard Extruded Colors



White



Almond



Clay

Double Strength Cardinal Glass

Argon Gas Filled Insulated Glass

Sloped Sill

(Envision Single + Double Hung)

Continuous Head + Sill On Mulls
Available

Integral Nailing Fin

Lifetime Warranty



Options Available with Vector Windows

Color Options

Woodgrain Laminate Interior



Laminate
Light Oak
Interior w/ White
or Clay Exterior.



Laminate
Dark Oak
Interior w/ White
or Clay Exterior.

Laminate Options



Laminate Black
Exterior &
Interior or
White Interior

Painted Exteriors



Bronze



Cocoa



Hunter
Green



Brick Red



Terratone



Black

Also available in almond, clay and custom color request.

Extension Jamb Available



White



Almond



Clay



Light
Oak



Dark
Oak



Oak



Pine



Knotty
Alder



Maple



Poplar



Primed

Wood Veneer. Other species available upon request.

Grids Options



Contoured



Flat Bar

Screen Options

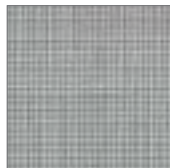

Visibility Insect
Screen



Flex Screen

Night Latches



Receiver Channel
(Loose or Applied)



Many Glass Options
(LoE, Tempered, Patterned Glass, Tints and Acoustic)



Retro Option
(Converts New Construction to Replacement)

WOCD'S (Window Opening Control Devices)
ASTM F2090 Compliant

Extension Jamb 4 9/16 - 7 5/8
(Loose or Applied)

Custom Sizes + Many More Options
[Learn more at vectorwindows.com](http://www.vectorwindows.com)



Envision Casement & Awnings

Envision Casement and Awning windows come in a wide range of sizes and configurations and can be complemented with geometric and radius shapes. The continuous main frame design gives these windows simple beauty you can take pride in.

Envision Casement

- 3 Points of Weatherstrip (Exterior Wind Block and 2 Additional Bulb Weatherstrip)
- Multi Point Lock (1 Lock Handle)
- 3 1/4 " Frame
- Washability Hinge
- Folding Handle
- No Exposed Fasteners On Screen

Envision Awning

- 3 Points of Weatherstrip (Exterior Wind Block and 2 Additional Bulb Weatherstrip)
- Multi Point Lock (2 Lock Handles)
- 3 1/4 " Frame
- Folding Handle
- No Exposed Fasteners On Screen



Envision Double-Hung/Single-Hung

Envision Series Double-Hung and Single-Hung windows provide the beauty of hassle-free operation, low maintenance and traditional styling. These windows open and close with ease. Give your home a distinctive look by combining with picture windows and specialty shapes.

- Triple Weatherseal
- Interlock Weatherstrip
- Storm Interlock at Sill
- Bulb Seal at Sill + Head*
- 3 1/4" Frame
- Sloped Sill
- Constant Force Balances
- Balance Covers
- Easy Tilt In Sash
- Full Screen on Double Hung



Envision Glider Window

Envision Glider windows offer a bold, traditional look, while heavy-duty construction and design deliver exceptional performance ratings. Our unique design brings the flexibility of radius tops, transoms to a popular.

- Triple Weatherseal
- Interlock Weatherstrip
- Teflon Slides
- 3 1/4" Frame
- Cam Lock + Keeper
- Removable Sash
- Double Glider + End Vent Glider Available





Advantage Single Hung

Advantage Single-Hung windows are a popular standard, built to last a lifetime. With their heavy-duty block and tackle system, these windows open and close with ease. They come in a wide range of sizes and configurations and can be combined with geometric shapes and radius units to create a custom look to fit any home.

- Perimeter Weatherstrip
- Side Load Sash
- Block and Tackle Balance
- 2 11/16" Frame
- Adjustable Cam Lock
- Removable Sash



Advantage Glider

Advantage Glider windows offer a sophisticated look. Advantage gliders are the answer for builders caught between style, performance and cost. Our unique design brings the flexibility of radius tops and transoms to a popular window.

- Perimeter Weatherstrip
- Brass Rollers
- Raised Glider Track
- 2 11/16" Frame
- Removable Sash
- Available in Center Vent and End Vent





Full View Patio Door

Full View Sliding patio doors incorporate enhanced performance and ease of installation in a door system that has all the flexibility needed for today's design trends. These ENERGY STAR® certified doors are built for high performance and compliments either style of windows you choose.

- Narrow Stiles + Rails
- Multi Point Lock Available
- 4 5/16" Frame
- Sliding Screen
- Optional Exterior Laminate Available





Advantage/Envision Specialty Windows

Give any home a custom look. At Vector, we can design specialty windows to your exact specifications. Use any of our non-standard shapes as single units, or combine them with any of our standard window systems.



- Multiple Sizes & Types Available

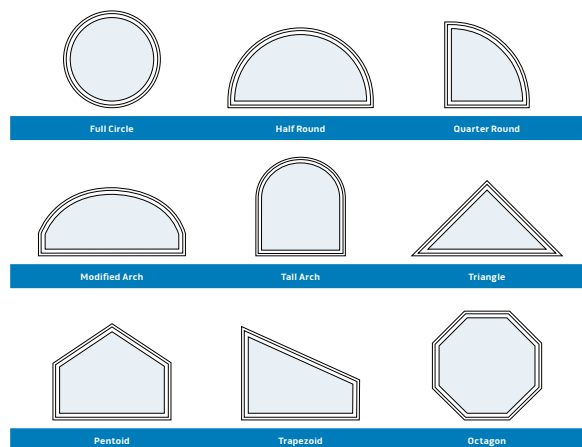

Test Performance Data

All Envision products meet or exceed the published results shown below for structural strength and air infiltration. Furthermore, all Vector windows and doors are tested and certified for thermal performance by National Fenestration Rating Council (NFRC). Quality and performance are assured through testing and plant inspections.

All data provided in accordance with all American Society for Testing and Materials (ASTM) guidelines set forth in NFRC-100/200/500 and AAMA / WDMA/CSA 101/I.S. 2/A440, NAFS - North American Fenestration Standard/ Specification for Windows, Doors and Skylights.

Due to continued ongoing product testing, the information provided can be changed by Vector at any time without notification. This data supersedes any previous data published by Vector.

Structural Performance Data

Product	Size Tested	Performance Grade	Air Infiltration	Forced Entry
Advantage Single Hung Window	48" X 78"	H-LC30	.14 CFM/FT ²	GRADE 10
Advantage Single Glider Window	72" X 60"	HS-R20	.12 CFM/FT ²	GRADE 10
Advantage Picture Window	60" X 60"	LC-PG30	<.01 CFM/FT ²	GRADE 10
Envision Casement Window	36" X 75"	R-PG50	.02 CFM/FT ²	GRADE 10
Envision Awning Window	48" X 32"	LC-PG55	.02 CFM/FT ²	GRADE 10
Envision Casement Fixed Window	72" X 75"	CW-PG50	<.01 CFM/FT ²	GRADE 10
Envision Single Hung Window	48" X 75"	LC-PG45	.04 CFM/FT ²	GRADE 10
Envision Double Hung Window	48" X 75"	LC-PG30	.05 CFM/FT ²	GRADE 10
Envision Single Glider Window	72" X 60"	LC-PG50	.08 CFM/FT ²	GRADE 10
Envision Double Glider Window	72" X 60"	LC-PG25	.07 CFM/FT ²	GRADE 10
Envision Picture Window	72" X 75"	CW-PG35	.01 CFM/FT ²	GRADE 10
Full View Sliding Patio Door	96" X 80"	R-PG20	.10 CFM/FT ²	GRADE 10
French Sliding Patio Door	96" X 82"	R-PG40	.07 CFM/FT ²	GRADE 10

Air Infiltration: ASTM E283 cubic feet per minute of air leakage per square footage of window or door.

Structural Performance: ASTM E330 pressure shown applied positive and negative to unit and held for 10 seconds, with no damage allowed.

Forced Entry Resistance: ASTM F 588 for windows, ASTM F 842 for patio doors.

Please go to Vector Windows website to see most current performance data.
www.vectorwindows.com

Test Performance Data

NFRC: Thermal & Solar Values		U-Value		R-Value		Solar Heat Gain		Visible Light		Condensation Resistance
		with or w/o Grilles	with or w/o Grilles	w/o Grilles	with Grilles	w/o Grilles	with Grilles	with or w/o Grilles		
Advantage Single Hung Window	LoE3	0.28	3.57	0.22	0.20	0.51	0.46	62		
	LoE2	0.29	3.45	0.33	0.30	0.57	0.51	61		
Advantage Single Glider Window	LoE3	0.28	3.57	0.22	0.20	0.51	0.46	62		
	LoE2	0.29	3.45	0.33	0.30	0.57	0.51	62		
Advantage Picture Window	LoE3	0.26	3.85	0.25	0.22	0.57	0.51	64		
	LoE2	0.27	3.70	0.37	0.34	0.64	0.57	63		
Envision Casement Dual Pane	LoE3	0.24	4.17	0.21	0.19	0.48	0.44	62		
	LoE2	0.25	4.00	0.31	0.29	0.54	0.49	62		
Envision Casement Triple Pane	LoE3	0.17	5.88	0.18	0.17	0.35	0.32	71		
	LoE2	0.17	5.88	0.27	0.24	0.43	0.39	70		
Envision Awning Dual Pane	LoE3	0.25	4.00	0.21	0.19	0.48	0.44	61		
	LoE2	0.25	4.00	0.31	0.29	0.54	0.49	60		
Envision Awning Triple Pane	LoE3	0.17	5.88	0.18	0.17	0.35	0.32	71		
	LoE2	0.17	5.88	0.27	0.24	0.43	0.39	71		
Envision Casement Fixed Dual Pane	LoE3	0.24	4.17	0.23	0.21	0.54	0.49	62		
	LoE2	0.25	4.00	0.35	0.32	0.60	0.54	61		
Envision Casement Fixed Triple Pane	LoE3	0.15	6.67	0.20	0.18	0.39	0.35	71		
	LoE2	0.16	6.25	0.30	0.27	0.48	0.43	70		
Envision Single Hung Dual Pane	LoE3	0.26	3.85	0.21	0.19	0.51	0.45	62		
	LoE2	0.27	3.70	0.32	0.29	0.56	0.50	62		
Envision Single Hung Triple Pane	LoE3	0.18	5.56	0.19	0.17	0.36	0.32	71		
	LoE2	0.18	5.56	0.28	0.25	0.45	0.40	70		
Envision Double Hung Dual Pane	LoE3	0.26	3.85	0.21	0.19	0.49	0.44	62		
	LoE2	0.27	3.70	0.32	0.29	0.55	0.49	62		
Envision Double Hung Triple Pane	LoE3	0.18	5.56	0.18	0.17	0.36	0.32	71		
	LoE2	0.18	5.56	0.27	0.24	0.44	0.39	71		

Please visit the Vector Windows website to see our most current performance data.

www.vectorwindows.com

Test Performance Data

NFRC: Thermal & Solar Values		U-Value	R-Value	Solar Heat Gain		Visible Light		Condensation Resistance
Product		with or w/o Grilles	with or w/o Grilles	w/o Grilles	with Grilles	w/o Grilles	with Grilles	with or w/o Grilles
Envision Single Glider Dual Pane	LoE3	0.26	3.85	0.21	0.19	0.50	0.45	63
	LoE2	0.27	3.70	0.32	0.29	0.56	0.50	62
Envision Single Glider Triple Pane	LoE3	0.17	5.88	0.19	0.17	0.36	0.32	74
	LoE2	0.18	5.56	0.28	0.25	0.45	0.40	74
Envision Double Glider Dual Pane	LoE3	0.26	3.85	0.21	0.19	0.48	0.43	60
	LoE2	0.27	3.70	0.31	0.28	0.54	0.48	61
Envision Double Glider Triple Pane	LoE3	0.18	5.56	0.18	0.16	0.35	0.31	61
	LoE2	0.19	5.26	0.26	0.24	0.43	0.38	65
Envision Picture Dual Pane	LoE3	0.25	4.00	0.22	0.20	0.53	0.47	62
	LoE2	0.26	3.85	0.34	0.31	0.59	0.52	61
Envision Picture Triple Pane	LoE3	0.16	6.25	0.20	0.18	0.38	0.34	71
	LoE2	0.17	5.88	0.29	0.26	0.47	0.42	70
Full View Sliding Patio Door	LoE3	0.27	3.70	0.23	0.20	0.53	0.46	61
	LoE2	0.28	3.57	0.34	0.30	0.59	0.52	60
French Sliding Patio Door	LoE3	0.28	3.57	0.19	0.17	0.45	0.39	62
	LoE2	0.29	3.45	0.29	0.26	0.50	0.44	61



Limited Lifetime Warranty

Vector Windows ("Vector"), hereby offers a warranty (the "Warranty") pursuant to the specific terms and provisions in this Warranty Document below.

Warranty

Pursuant to the terms, provisions, and limitations set forth in this Warranty Document, Vector hereby guarantees to the original consumer purchaser ("Original Purchaser") of Products (as defined below) that Vector will repair or replace any such Products that are defective in materials or workmanship and will pay the costs of all parts related to such repair or replacement and will pay the costs of all labor for the first two years. Whether Products are to be repaired or replaced will be determined by Vector, in its sole discretion. If repair is not commercially practical or cannot be made in a timely fashion, then Vector will replace any defective Products with replacement Products. Additionally, Vector, at its sole discretion, reserves the option to refund the purchase price for the Products rather than to repair or replace the Products. Vector reserves the right to modify or discontinue any of its Products. For the repair or replacement of modified or discontinued Products, Vector will have the right to substitute current Products and components of equal quality and as similar in appearance as possible.

Covered Products

For purposes of this Warranty Document, "Products" mean any of the following: Vector windows or doors installed in a single family home (a "Home") by the builder as new construction or by the Original Purchaser as replacements.

Persons & Times Covered

The Warranty starts on the date of purchase of the Home as new construction or the installation of Products in the Home as replacements (the "Start Date") and remains effective as long as the Original Purchaser owns and resides in the Home. Additionally, if the Original Purchaser sells the Home before ten (10) years has elapsed after the Start Date, the Warranty will be automatically transferred to the new owner(s) of the Home and any subsequent owners, based on the schedule of coverage listed in the paragraph below. The Warranty shall only be enforceable during the Warranty time periods described in this paragraph, the chart below, and the paragraph describing coverage for subsequent homeowners, and by the Original Purchaser or subsequent owner(s) that are provided rights under the Warranty in this paragraph and the chart below.

Homes Owned & Occupied by the Original Purchaser	
Coverage	Duration
Insulated Glass Unit (Seal Failure)	Lifetime
Vinyl Frame & Sash	Lifetime
Hardware	Lifetime
Product Related Labor (Excludes any installation or removal costs)	2 Years

Exterior laminates applied by Vector to vinyl surfaces are considered part of the vinyl frame and sash and coverage includes cracking, peeling, or non-uniform fading discoloration. This coverage does not extend to discoloration or surface damage, caused by an environmental factor or the use of natural or chemical solvents causing such damage.

Coverage for Subsequent Homeowners

For owners subsequent to the Original Purchaser, insulated glass units are warranted against hermetic seal failure resulting in moisture between the glass panes at 100% of the material cost for the first ten (10) years, and at 50% of the material cost for years 11–20. Hardware and vinyl frame and sash parts are warranted against material defects at 100% of the material cost for ten (10) years. Labor coverage is included for the first two (2) years from the date of installation.

Registration

The Warranty must be registered within 90 days of the Start Date (the "Registration Period"). The only way to register the Warranty is online at VectorWindows.com/Warranty/Registration. If the Warranty is not so registered with Vector within the registration period, the Warranty coverage will default to the coverage provided to subsequent homeowners as described in the chart above, notwithstanding anything in this Warranty Document to the contrary.

Exceptions For Screens

Notwithstanding anything in this Warranty Document to the contrary, the Warranty will cease and end on the one (1) year anniversary of the Start Date for the following components of the Products: window screen frames, window screen mesh, door screen frames, and door screen mesh.

Exclusions From Coverage

Notwithstanding anything in this Warranty Document to the contrary: (a) the Warranty does not cover damage or defects relating to misuse, abuse, the use of applied tints or films, damage resulting from acid wash, alterations including but not limited to customer applied finishes, modifications of the Product or components, such as field mulls, normal wear and tear, broken glass, natural weathering of exterior finishes, acts of God (for example, fires, hurricanes, tornadoes, storms, etc.), building settling, structural failures of walls or foundations, improper installation, improper storage, improper handling, or failure to properly care for and maintain the Products; and (b) normal wear, including discoloration, on hardware component finishes is not a defect and is not covered by the Warranty; and (c) for Products with argon gas filled insulating glass, the gradual dissipation of insert gas that occurs naturally over time is not a defect and is not covered by the Warranty; and (d) wood and wood veneered extension jambs are not covered by the Warranty. (e) Insulated glass with blinds between the glass is not covered under this warranty. (f) Painted products applied by Vector are limited to a 15-year warranty on exterior paint only and are subject to normal wear and fading.

Glass Breakage & Stress Cracks

As referenced above, the Warranty does not extend to glass breakage, with the exception of Stress Cracks as determined by a Vector representative. Stress Cracks are covered for a period of 2 years.

No Other Warranties & Exclusive Remedy

The Warranty and the liabilities and obligations thereto are in lieu of all other warranties, liabilities, and obligations, including all warranties of merchantability, of fitness for a particular purpose or otherwise, expressed or implied, in fact or by law. The Warranty states Vector's entire and exclusive liability and the exclusive remedy of the Original Purchaser and any subsequent owner of the Home for any claim in connection with the Products.

Limitations

In no event will Vector be liable for any direct, indirect, special, incidental or consequential damages whatsoever, whether based on breach of express or implied warranty, breach of contract, negligence, strict liability or any other legal theory; and Vector's liability, under no circumstances, will exceed the purchase price for the defective Products under Warranty.

033120



Vector Windows

1020 International Dr.
Fergus Falls, MN 56537

OFFICE 800.739.9899

FAX 888.739.9799

VectorWindows.com

